

SAVE THESE INSTRUCTIONS
GATE LEG TABLE ASSEMBLY INSTRUCTIONS
STYLE #: 54SNR4302HAZ
ASSEMBLE ON A FLAT, PROTECTED SURFACE

STEP 1

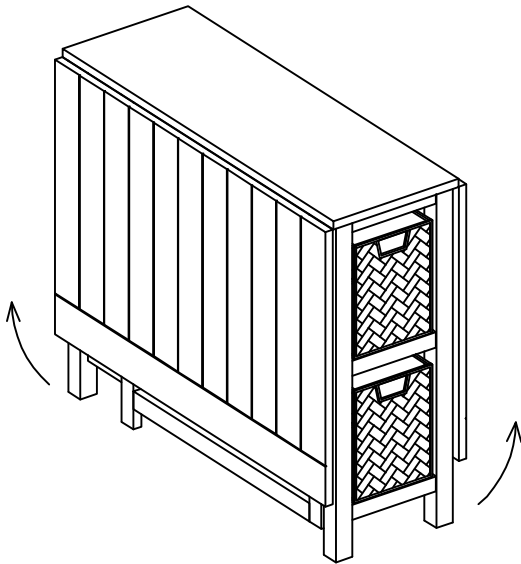

A. PULL UP 2 LEAVES OF TABLE TOP; SWING LEGS OUT.

STEP 2

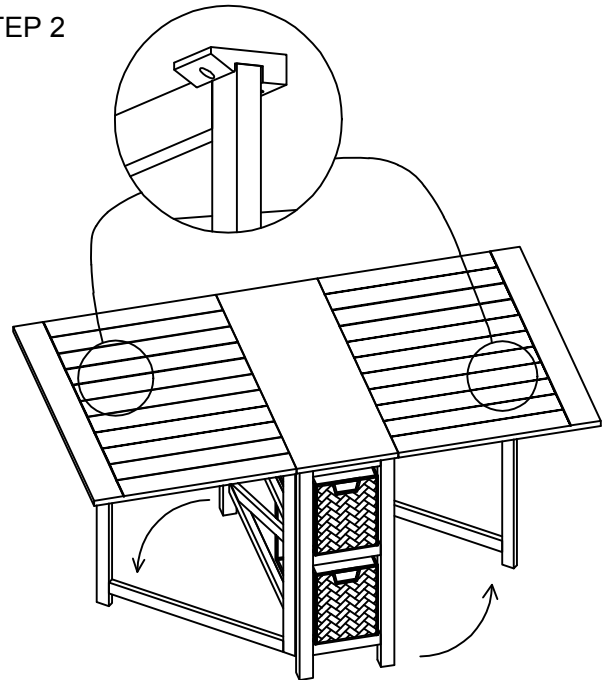

A. SECURE GATE LEG UNDER TABLE TOP BY INSERTING LEG TOP IN WOOD LOCK UNDER LEAVES.

STEP 3

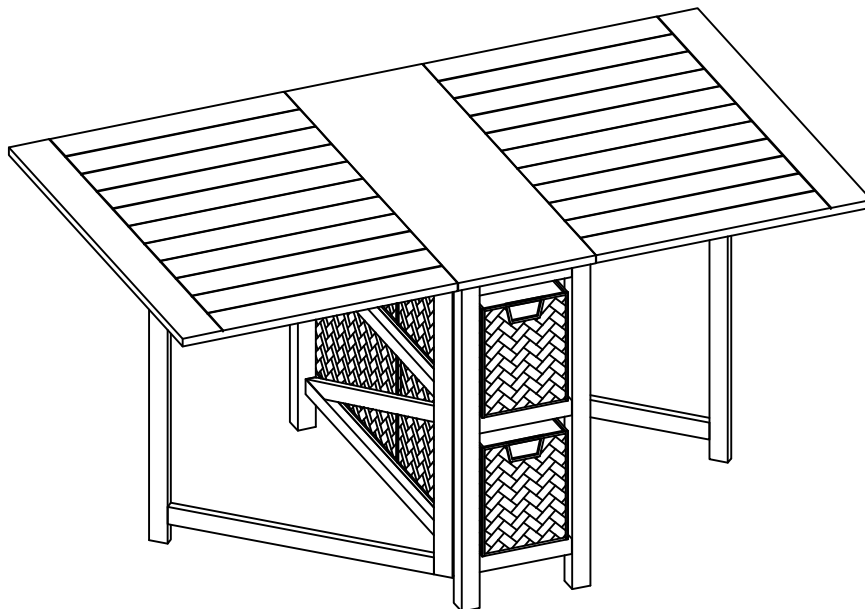

A. THE GATE LEG TABLE IS NOW READY FOR USE.

1. WIPE CLEAN WITH A SOFT, DRY CLOTH AS NEEDED.
2. BASKETS: DO NOT BRING IN CONTACT WITH WATER OR LIQUIDS. WIPE CLEAN WITH A SOFT, DRY CLOTH AS NEEDED. DUE TO THE NATURAL MATERIAL OF THIS ITEM, VARIATION IN COLOR MAY BE PRESENT.
3. DO NOT SIT, STAND OR CLIMB ON TABLE.
4. WEIGHT RESTRICTION: TOP CLOSED: 200 LBS, OPEN LEAF: 40 LBS, SHELVES: 60 LBS EACH, BASKET: 15 LBS EACH.
5. INTENDED FOR INDOOR USE ONLY.